

8/9/2024 12:36 PM c:\pds\cadd\sdskprca\2023\23-088\PLANS\Construction Drawings\Site Development\PLANS\CD PLANS\23-088 Madisonville Park Development_CD.dwg

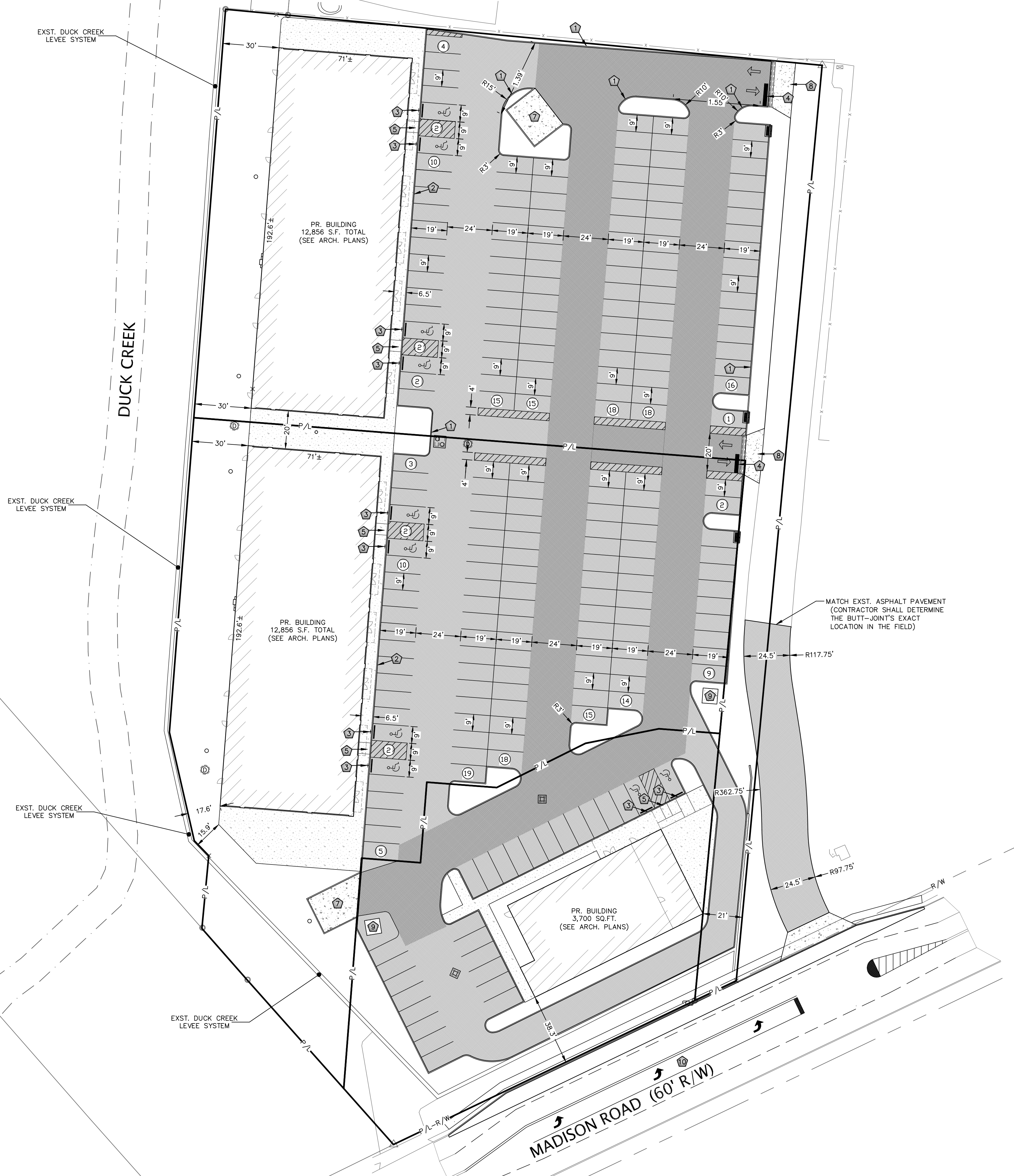

GENERAL NOTES:

- CURB RADII SHOWN ARE TO FACE OF CURB/EDGE OF PAVEMENT UNLESS OTHERWISE NOTED.
- BUILDING DIMENSIONING AS SHOWN IS FROM FACE OF WALL, CURB OR OTHER FIXED POINT AND IS FOR SITE LAYOUT AND GENERAL INFORMATION ONLY. REFER TO ARCHITECTURAL DRAWINGS FOR COMPLETE BUILDING DIMENSIONING PRIOR TO CONSTRUCTION.
- CONTRACTOR SHALL INCORPORATE CONSTRUCTION AND EXPANSION JOINTS IN CONCRETE PAVEMENT. CONCRETE JOINTS AS PER STANDARD CONSTRUCTION PRACTICES.
- CONCRETE PAVEMENT EXPANSION JOINTS SHALL BE AT ALL BUILDING/WALK AND WALK/PAVEMENT INTERFACES. ALIGN CONTROL JOINTS WITH COLUMNS AND BUILDING ROJECTIONS AND EVENLY DISTRIBUTE SAID CONTROL JOINTS IN BETWEEN.
- THE CONTACTOR WILL PROVIDE DIGITAL PICTURES OF CONDITIONS BEFORE, DURING, AND AFTER CONSTRUCTION NEAR THE FLOODWALL. THESE PHOTOS ARE TO BE SUBMITTED TO BOTH THE LEVEE SPONSOR AND THE USACE LEVEE SAFETY AREA REPRESENTATIVE, ANDREW BROOKS (ANDREW.T.BROOKS@USACE.ARMY.MIL), WITHIN 30 DAYS OF COMPLETION OF THE APPROVED PROJECT.
- THE CONTRACTOR SHALL COMPLETE AS-BUILT DRAWINGS OF ALL FINAL FEATURES WITHIN 50 FEET OF THE FLOODWALL CENTERLINE WHERE CONSTRUCTION ACTIVITIES WILL OCCUR AND PROVIDE THEM TO BOTH THE LEVEE SPONSOR AND THE USACE LEVEE SAFETY AREA REPRESENTATIVE, ANDREW BROOKS AT (ANDREW.T.BROOKS@USACE.ARMY.MIL) WITHIN 30 DAYS OF COMPLETION OF THE APPROVED PROJECT.
- THE CONTRACTOR SHALL BE RESPONSIBLE FOR ANY DAMAGE TO THE EXISTING FLOODWALL OR LEVEE DURING CONSTRUCTION. DAMAGES SHALL BE REPAIRED BY THE CONTRACTOR AT THEIR EXPENSE. IF DAMAGES BEYOND THE APPROVED SCOPE OF WORK OCCUR, THE CONTRACTOR SHALL IMMEDIATELY CONTACT THE LEVEE SPONSOR AND THE USACE LEVEE SAFETY AREA REPRESENTATIVE, ANDREW BROOKS AT 502-315-6576.
- PLEASE PROVIDE NOTICE TO USACE AT LEAST ONE WEEK PRIOR TO CONSTRUCTION NEAR THE FLOODWALL AREA TO ALLOW A USACE REPRESENTATIVE THE OPTION TO BE ON SITE. POC IS ANDREW BROOKS AT 502-315-6576.
- ANY MODIFICATION TO THE APPROVED SUBMITTALS DEEMED NECESSARY DURING THE CONSTRUCTION PHASE OF THE PROJECT MAY REQUIRE ADDITIONAL TECHNICAL REVIEW AND APPROVAL BY THE USACE PRIOR TO CONTINUING CONSTRUCTION. CONSULT THE USACE LEVEE SAFETY AREA REPRESENTATIVE, ANDREW BROOKS, TO DETERMINE IF THIS REVIEW IS NECESSARY.

SITE KEY NOTES:

- CONCRETE HEADER CURB, REFERENCE DETAIL 7/C-200.
- TURNED DOWN CONCRETE CURB AND SIDEWALK, REFERENCE DETAIL 10/C-200.
- HANDICAP PARKING SIGN & POST, REFERENCE DETAIL 9/C-200.
- PAVEMENT MARKING, STOP BAR, PER OMUTCD.
- ADA CURB RAMP WITH FLARED SIDES, REFERENCE DETAIL 11/C-200.
- MONUMENT SIGN (DESIGN BY OTHERS). REFERENCE ARCH. DWGS. FOR MORE INFORMATION AND DETAILS.
- DUMPSTER ENCLOSURE, REFERENCE DETAIL 10/C-240.
- CONCRETE APRON W/ TRENCH DRAIN.
- CONCRETE TRANSFORMER PAD. REFERENCE DETAILS SHEET C-250.
- FINAL TURN LANE DESIGN TO BE SUBMITTED UNDER SEPARATE PERMIT.

SITE PLAN LEGEND

- PROPOSED LIGHT DUTY ASPHALT PAVEMENT PER 1/C-240
- PROPOSED HEAVY DUTY ASPHALT PAVEMENT PER 2/C-240
- PROPOSED CONCRETE PAVEMENT REFER TO KEYNOTES, THIS SHEET

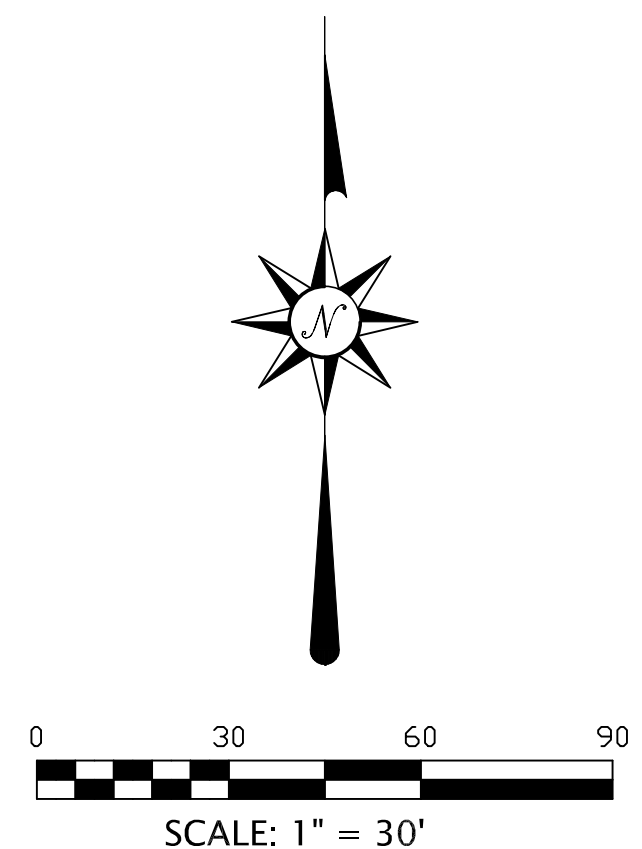

REVISIONS		
DATE	#	ITEM
07-18-24	1	REV PER SMU
08-08-24	2	REV PER BLDG DEPT REVIEW

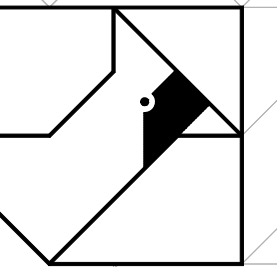

CARDINAL

ENGINEERING
LAND SURVEYING
ONE MOOCK ROAD
WILDER, KENTUCKY 41071
PHONE: (859) 581-9600
FAX: (859) 581-9636

WEBSITE: <http://www.cardinalengineering.net>

CIVIL SITE IMPROVEMENT DRAWINGS
OAKLEY PARK
4710 MADISON ROAD
CINCINNATI, OHIO

MORELIA GROUP
8600 GOVERNORS HILL DRIVE, SUITE 160
CINCINNATI, OHIO 45249
PH: (513) 469-1500 WWW.MORELIAGROUP.COM

DRAWN BY:
BCC
CHECKED BY:
ZAC
PROJECT MANAGER:
JSF

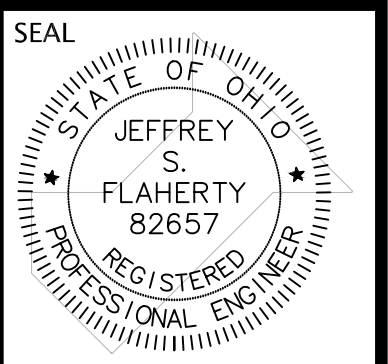

PROJECT NO. 23-088
SCALE 1" = 30'
DATE 09/22/2023

SITE LAYOUT / DIMENSION
PLAN

SHEET
C-400